

## Varioflexleitungen mit TÜV

### Varioflex lines

### Durites des freins renforcées, système Varioflex

#### Varioflexleitungen mit Teilegutachten

- einschraubbare Anschlüsse aus Aluminium in sechs verschiedenen Farben
- verschiedene Anschlüsse in Edelstahl lieferbar
- hohe Flexibilität in der Lagerhaltung
- deutliche Verbesserung des Druckpunktes
- aussagefähige Montageanleitung
- Leitungen transparent oder schwarz ummantelt
- Leitungen nach FMVSS 106 gefertigt
- Teflon Innenseele, außen vierfadiges Stahlgewebe

#### Varioflex lines

- threaded alloy connections available in 6 different colors
- several connections are available in stainless steel
- increase stocking flexibility
- marked improvement of the pressure point
- informative fitting instruction
- protective transparent or black plastic sleeve
- varioflex lines comply with standard FMVSS 106
- teflon core, four-thread braided steel covering

#### Durites de freins renforcées, système varioflex

- raccords filetés en aluminium, disponibles en 6 couleurs différentes
- différents raccords sont disponibles en acier
- permet une grande flexibilité en terme de stockage
- amélioration sensible du point de pression
- instructions de montage détaillées
- recouverts d'une couche protectrice noire ou transparente
- conduits réalisés selon la norme FMVSS 106
- durite téflon, renforcée par une tresse 4 branches en acier



**Varioflex  
mit TÜV-  
Gutachten!**

**Zur Komplettierung einer Bremsleitung  
bitte Anschlüsse, Leitungen und Dichtringe  
separat bestellen!**

*To complete the brake line, please order  
lines, connectors and seals separately!*

*Pour réaliser un kit durite, merci de  
commander les raccords, les durites  
et les joints au-dessus!*

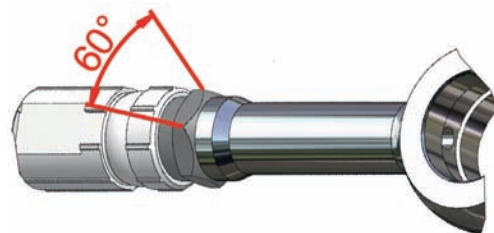

**Verdrehbare  
Anschlüsse!**

*Twistable  
connections!*

*Raccordements  
souples!*

**Längenübersicht**  
*Length chart*  
*Tableau des longueurs*



**Verpresste Stahlflexleitungen mit individuell einschraubbaren Fittingen**  
*Pressed steel flex lines with screw-in fittings, length overview*  
*Durite acier avec sertissage des écrous extérieurs par longueur*

**T = transparent ummantelt**  
*T = clear covering*  
*T = gaine de protection transparente*

**S = schwarz ummantelt**  
*S = black covering*  
*S = gaine de protection noire*

13 cm	<b>MV 013T/S</b>
15 cm	<b>MV 015T/S</b>
18 cm	<b>MV 018T/S</b>
21 cm	<b>MV 021T/S</b>
23 cm	<b>MV 023T/S</b>
25 cm	<b>MV 025T/S</b>
27 cm	<b>MV 027T/S</b>
29 cm	<b>MV 029T/S</b>
31 cm	<b>MV 031T/S</b>
33 cm	<b>MV 033T/S</b>
35 cm	<b>MV 035T/S</b>
37 cm	<b>MV 037T/S</b>
39 cm	<b>MV 039T/S</b>
41 cm	<b>MV 041T/S</b>
43 cm	<b>MV 043T/S</b>
45 cm	<b>MV 045T/S</b>
47 cm	<b>MV 047T/S</b>
49 cm	<b>MV 049T/S</b>
51 cm	<b>MV 051T/S</b>
53 cm	<b>MV 053T/S</b>
55 cm	<b>MV 055T/S</b>
57 cm	<b>MV 057T/S</b>
60 cm	<b>MV 060T/S</b>
63 cm	<b>MV 063T/S</b>
66 cm	<b>MV 066T/S</b>
69 cm	<b>MV 069T/S</b>
72 cm	<b>MV 072T/S</b>
75 cm	<b>MV 075T/S</b>
78 cm	<b>MV 078T/S</b>
81 cm	<b>MV 081T/S</b>
84 cm	<b>MV 084T/S</b>
87 cm	<b>MV 087T/S</b>
90 cm	<b>MV 090T/S</b>
93 cm	<b>MV 093T/S</b>
96 cm	<b>MV 096T/S</b>
99 cm	<b>MV 099T/S</b>
102 cm	<b>MV 102T/S</b>
105 cm	<b>MV 105T/S</b>
108 cm	<b>MV 108T/S</b>
110 cm	<b>MV 110T/S</b>
113 cm	<b>MV 113T/S</b>
115 cm	<b>MV 115T/S</b>
118 cm	<b>MV 118T/S</b>
120 cm	<b>MV 120T/S</b>
123 cm	<b>MV 123T/S</b>
126 cm	<b>MV 126T/S</b>
129 cm	<b>MV 129T/S</b>
131 cm	<b>MV 131T/S</b>
134 cm	<b>MV 134T/S</b>
137 cm	<b>MV 137T/S</b>
140 cm	<b>MV 140T/S</b>
143 cm	<b>MV 143T/S</b>
146 cm	<b>MV 146T/S</b>
149 cm	<b>MV 149T/S</b>
152 cm	<b>MV 152T/S</b>
155 cm	<b>MV 155T/S</b>
158 cm	<b>MV 158T/S</b>
161 cm	<b>MV 161T/S</b>
165 cm	<b>MV 165T/S</b>
167 cm	<b>MV 167T/S</b>
170 cm	<b>MV 170T/S</b>
174 cm	<b>MV 174T/S</b>
177 cm	<b>MV 177T/S</b>
181 cm	<b>MV 181T/S</b>
185 cm	<b>MV 185T/S</b>
189 cm	<b>MV 189T/S</b>
193 cm	<b>MV 193T/S</b>
197 cm	<b>MV 197T/S</b>
200 cm	<b>MV 200T/S</b>



# Anschlüsse Varioflexleitungen

## Connectors Varioflex lines

### Raccords pour système Varioflex

MV 10A00

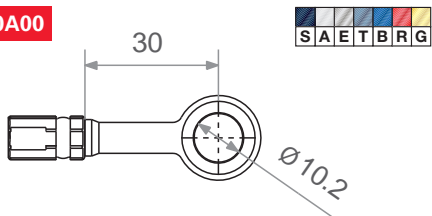

MV 11A00

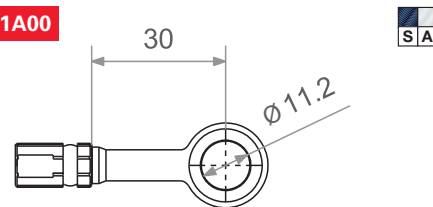

MV 10B00

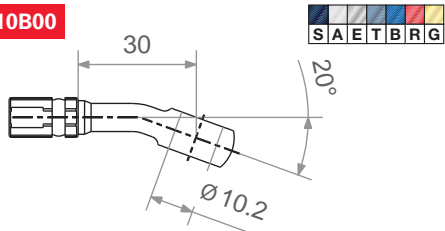

MV 11B20

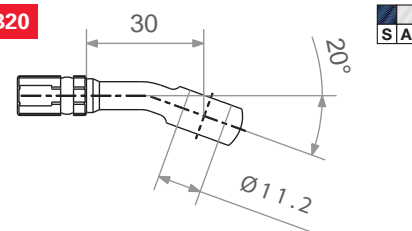

MV 10B30

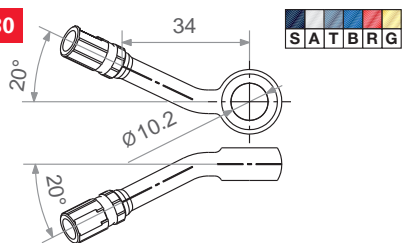

MV 10B40

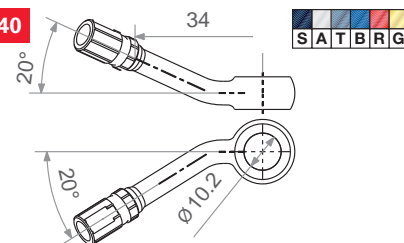

MV 10E20

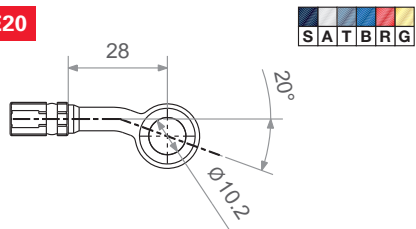

MV 10C45

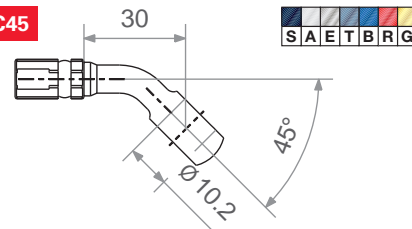

- = Schwarz, black, noire
- = Aluminium, aluminium
- = Edelstahl, stainless steel, inox
- = Titan, titanium, titane
- = Blau, blue, bleu
- = Rot, red, rouge
- = Gold, gold, aurifère

MV 11C45

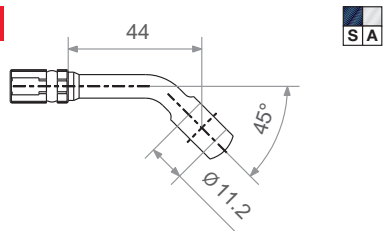

MV 10D90

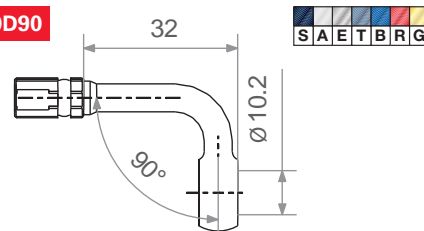

MV 11D90

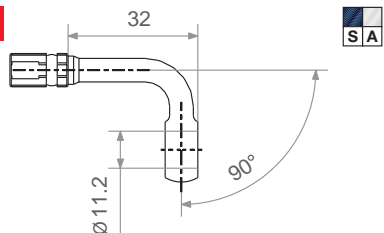

MV 10K00

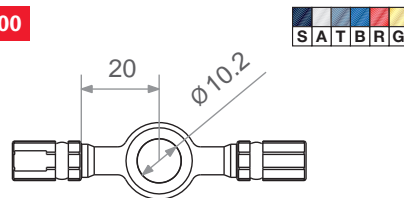

MV 988

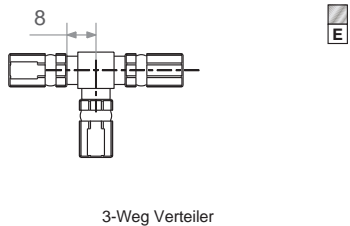

MV 989

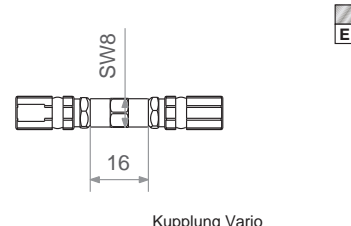

**MVF 100**

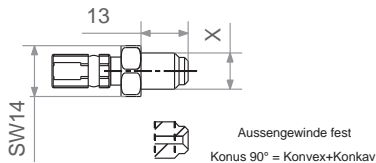

**MVF 225**

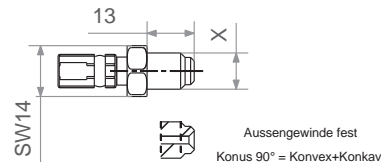

**MVF 400**

M10x1.00

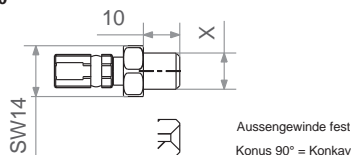

**MVF 900**

M10x1.00

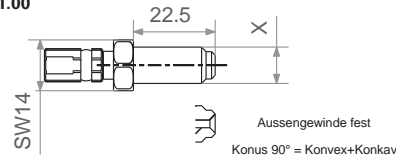

**MVG 100**

M10x1.25

**MVG 225**

M10x1.25

**MVG 38**

3/8"-24 UNF

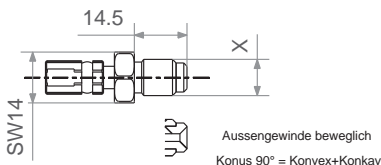

**MVH 100**

M10x1.00

**MVH 225**

M10x1.25

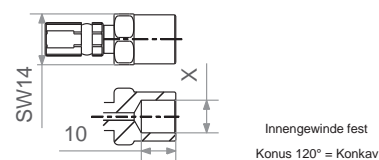

**MVH 400**

M10x1.00

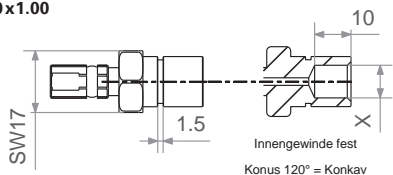

**MVJ 100**

M10x1.00

**MVJ 225**

M10x1.25

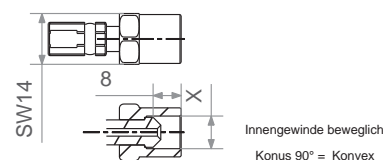

**Dichtringe:**

**MCH 991 W20** (Ø 10 mm, 20 Stück)

**MCH 991 W50** (Ø 10 mm, 50 Stück)

für Harley Davidson:

**MCH 990 W10** (Ø 11,2 mm, 10 Stück)

**Aluminium washers:**

**MCH 991 W20** (Ø 10 mm, 20 pcs.)

**MCH 991 W50** (Ø 10 mm, 50 pcs.)

for Harley Davidson:

**MCH 990 W10** (Ø 11,2 mm, 10 pcs.)

**Joints aluminium:**

**MCH 991 W20** (Ø 10 mm, 20 pièces)

**MCH 991 W50** (Ø 10 mm, 50 pièces)

pour Harley Davidson:

**MCH 990 W10** (Ø 11.2 mm, 10 pièces)

**Bestellbeispiel Varioflex:**

Bremsleitung 21 cm (transparent): **MV 021 T**  
 Bremsleitung 115 cm (schwarz): **MV 115 S**  
 Ringanschluss gerade (titan): **MV 10A00 T**  
 Ringanschluss 90° (schwarz): **MV 10D90 S**

**Ordering example:**

brake line 21 cm (clear covering): **MV 021 T**  
 brake line 115 cm (black): **MV 115 S**  
 straight banjo (titanium): **MV 10A00 T**  
 90° banjo (black): **MV 10D90 S**

**Exemple de commande:**

longueur de durite 21 cm (transp.): **MV 021 T**  
 longueur de durite 115 cm (noire): **MV 115 S**  
 raccord droit (titane): **MV 10A00 T**  
 raccord 90° (noire): **MV 10D90 S**

